

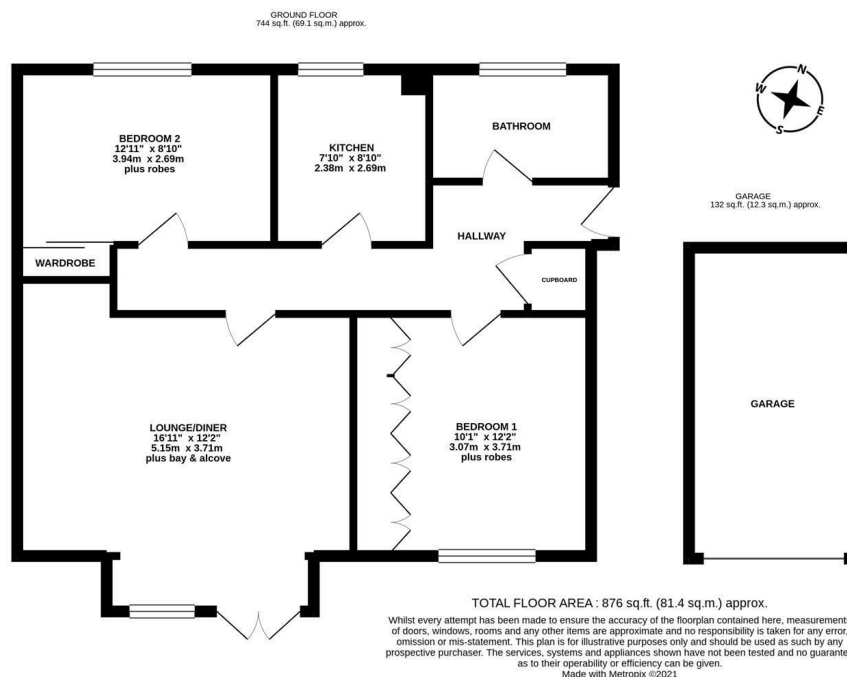

Modern Two Bedroom Apartment with Garage & No Onward Chain! Set behind well manicured communal gardens, this two bedroom ground floor apartment is ideally located within Preston Towers, Preston Village, North Shields. Preston Towers, tucked just off Preston Road North is perfectly placed to provide access to local transport links, shops, schools and leisure facilities including Tynemouth Golf Club.

Offered to the market with no onward chain, the accommodation briefly comprises: Entrance hall with storage cupboard; lounge diner measuring almost 17ft with feature fireplace and south-east facing French door access to the communal gardens; kitchen with fitted units and work surfaces; bathroom with three piece suite; two double bedrooms, both measuring 12ft with fitted wardrobe storage. Externally, well manicured communal gardens to the front, laid mainly to lawn with mature planting hedges and trees. To the rear, a private garage providing storage/off street parking. Early viewings are strongly advised!

Modern Two Bedroom Apartment | 876 Sq ft (81.4m²) | Lounge Diner with French Doors | Kitchen | Well Manicured Communal Gardens | Garage | No Onward Chain | Lease Length: 999 years remaining | Service Charge £1283.54 Per Annum | Council Tax Band: C | EPC: C



Offers Over £160,000

IMPORTANT NOTE: These particulars and the descriptions and measurements herein do not constitute representation and whilst every effort has been made to ensure accuracy, this cannot be guaranteed.

